

Mufa PE100 GZ (elektrooporowa)

ciśnienie PN16

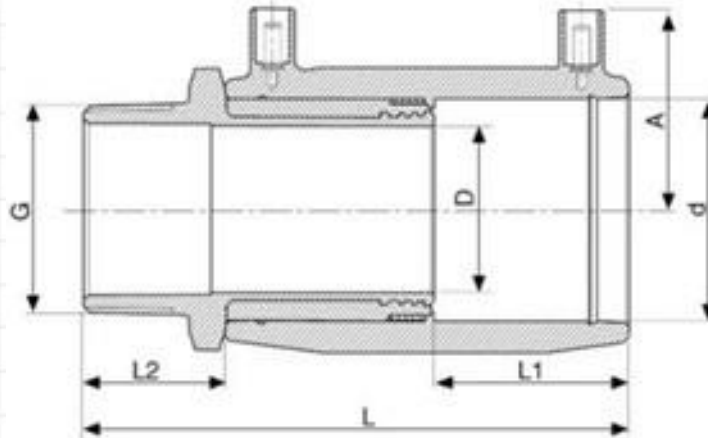

średnica d x G	l	l1	l2	D	A	Waga /g/
20 x 1/2"	105	37	29	14	35	130
25 x 3/4"	111	40	29	19	38	145
32 x 1/2"	119	44	29	23	41	241
32 x 3/4"	119	44	29	23	41	263
32 x 1"	124	44	34	23	41	277
32 x 1 1/4"	126	44	36	23	41	393
32 x 1 1/2"	126	44	36	23	41	404
40 x 1"	132	48	34	29	45	405
40 x 1 1/4"	134	48	36	29	45	455
40 x 1 1/2"	134	48	36	29	45	480
40 x 2"	139	48	41	29	45	500
50 x 1"	135	49	34	38	50	510
50 x 1 1/4"	137	49	36	38	50	560
50 x 1 1/2"	137	49	36	38	50	545
50 x 2"	142	49	41	38	50	730
63 x 1 1/4"	154	57	36	48	57	889
63 x 1 1/2"	154	57	36	48	57	825
63 x 2"	159	57	41	48	57	910
75 x 2"	167	62	41	59	63	1300
75 x 2 1/2"	172	62	46	59	63	1500